

_____ Project name
 _____ Prepared by
 / / Date

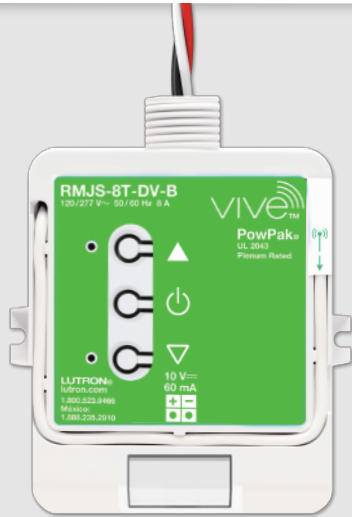

AirLink™ 8AMP Power Pack with 0–10V Dimming

enabled by Lutron®



Catalog #: **ALPP 8AD**
 or **ALPP 8AD BAA**
 Part #: **650299** or **655147**

The 8AMP power pack with 0–10V $\overline{\text{=}}$ dimming is a radio frequency (RF) device that operates 0–10V $\overline{\text{=}}$ controlled fluorescent ballasts or LED drivers based on input from wireless switches & ceiling-mounted wireless sensors. Communication with RF input devices, such as wireless switches and ceiling-mounted wireless sensors (daylighting, occupancy or vacancy), is accomplished using Lutron Clear Connect RF Technology.

Applications



Small offices



Conference rooms



Classrooms



Lounges

Features

- Controls up to 60mA of 0–10V $\overline{\text{=}}$ controlled fixtures together. 0–10V $\overline{\text{=}}$ control link automatically sources or sinks to 3rd-party fixtures
- Capable of switching 8A total
- Configurable high- and low-end trim. LED status indicator shows current load status and provides programming feedback
- Receives wireless inputs from up to 10 wireless switches, 10 ceiling-mounted wireless occupancy/vacancy sensors, and 1 ceiling-mounted wireless daylight sensor
- Mounts to a junction box through a standard-size knockout
- Power failure memory: If power is interrupted, connected loads will return to the previous level prior to interruption
- 0–10V $\overline{\text{=}}$ control miswire protection up to 30V $\overline{\text{=}}$
- Programming lockout can be enabled for public spaces
- 0–10V $\overline{\text{=}}$ control can be programmed to be inverted for 10–0V $\overline{\text{=}}$ control

Specifications

Regulatory Approvals

- COFETEL and NOM (Mexico) (ALPP 8AD only)
- cUL $\text{\textcircled{R}}$ and IC (Canada) (ALPP 8AD only)
- Complies with requirements for use in other spaces used for environmental air (plenum) per NEC $\text{\textcircled{R}}$ 2011 300.22(C)(3)
- UL $\text{\textcircled{R}}$ Listed, UL 2043 Plenum Rated and FCC Approved. Complies with the limits for a Class B digital device, pursuant to Part 15 of the FCC rules
- Listed in accordance to CAN/ULC S102.2-2010 with a Flame Spread Rating of 0 and a Smoke Developed Classification of 40, with a minimum spacing of 6ft (1.83m) off center

Certifications & Affiliations





Specifications (continued)

Power / Load

- Operating voltage: 120 – 277V \ominus 50/60 Hz
- Maximum load: 8A general purpose, no minimum
- Output ratings: switch rate of 8A. Rated for resistive or capacitive loads as defined by IEC/EN 60669-2-1, 0-10V control link for 60mA maximum output, source sink automatically configures
- Standby power: 240 – 277V \ominus 610mW, 120V \ominus 550mW
- BTU/hour when fully loaded: 9
- Works with all ballasts and drivers that provide a current source that is compliant to IEC 60629 Annex E.2, and whose inrush current does not exceed NEMA410 standards for electronic ballast/driver

Environmental

- Ambient Operating Temperature: 32°F to 131°F (0°C to 55°C), 0–90% humidity, non-condensing; indoor use only

Control Link

- Communicates with up to 60mA of fixtures
- Control link is IEC SELV/NEC® Class 2
- 0–10V control can be installed using NEC® Class 1 or Class 2 wiring methods. Alternately, it can be wired to basic or double-insulated devices
- Terminals accept one 18AWG to 16AWG (0.75mm² to 1.5mm²) solid wire. Always consult local wiring codes
- Compatible with ANSI E1.3 2001 (R2006), IEC 60929 Annex E

Default Operation

- Associated wireless input devices control all connected fixtures together
- Occupancy sensors: Occupied = 100%; Unoccupied = 0% (OFF)
- AirLink wireless switches: On = 100%; Favorite Level = 50%; Off = 0% (OFF)
- Daylight Sensor: Decreases electric light in response to additional available daylight

Ordering Information

Part #	Catalog #	Description
650229	ALPP 8AD	AirLink System – 8AMP Power Pack with 0–10V Dimming
655147	ALPP 8AD BAA	AirLink System – 8AMP Power Pack with 0–10V Dimming, BAA certified



AirLink™ 8AMP Power Pack with 0–10V Dimming

enabled by Lutron®

Dimensions

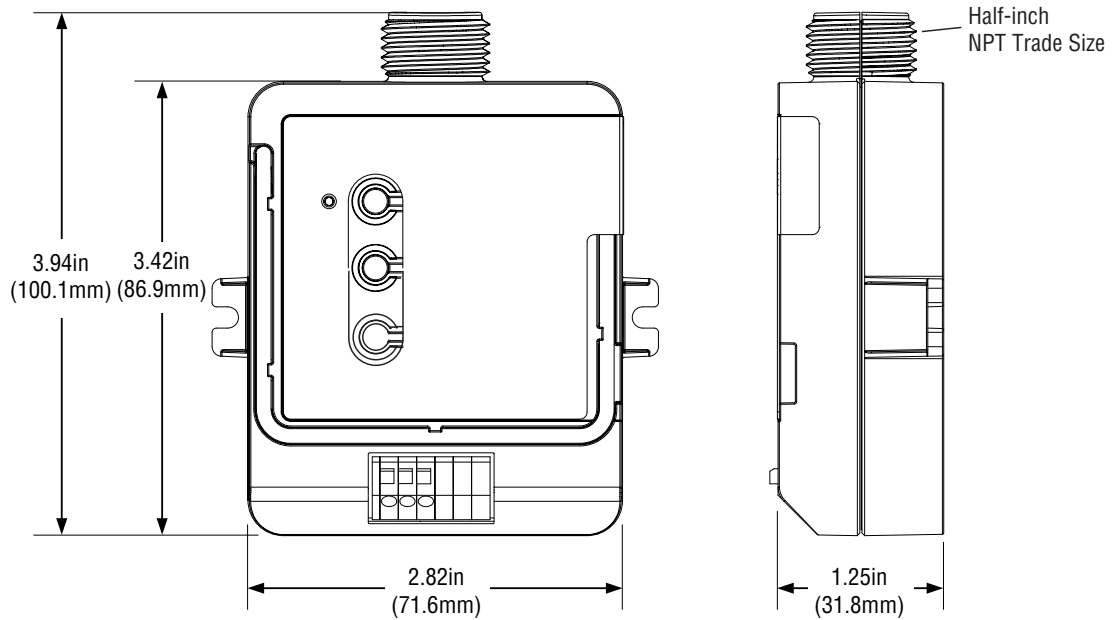

Fixture Range

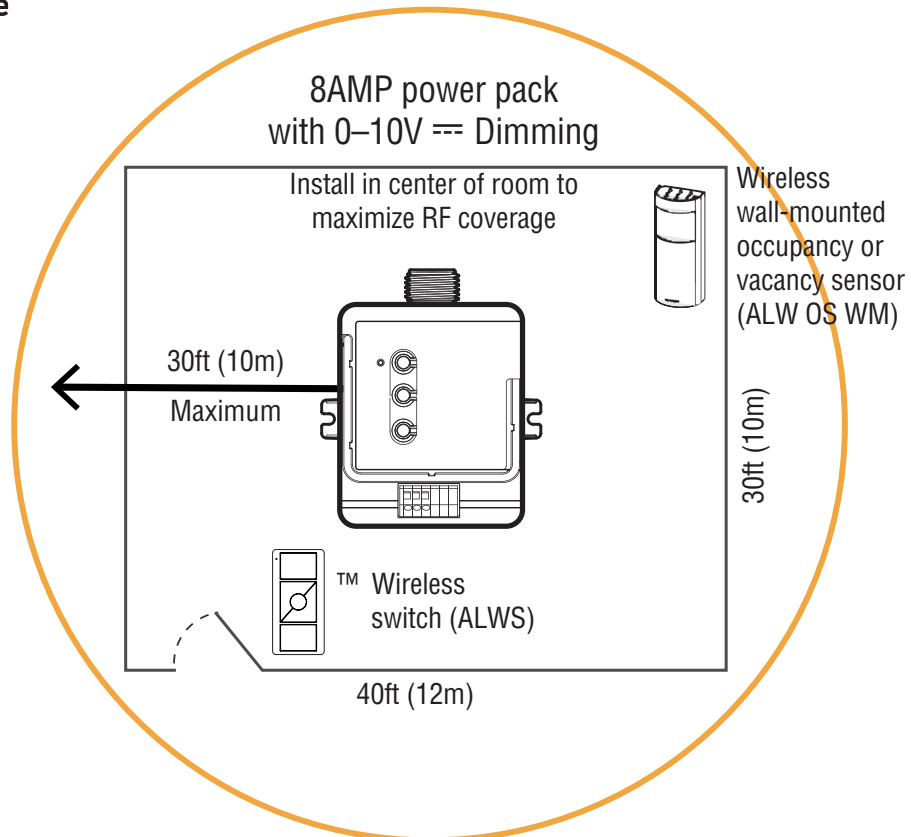



AirLink™ 8AMP Power Pack with 0-10V Dimming

enabled by Lutron®

Wiring Diagram

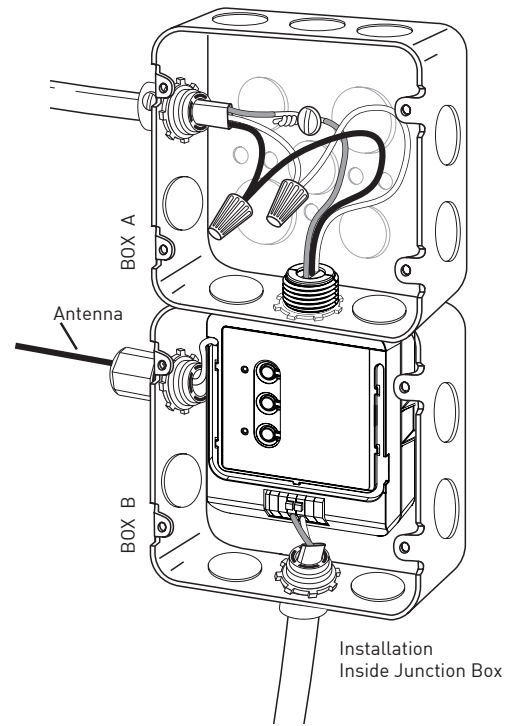
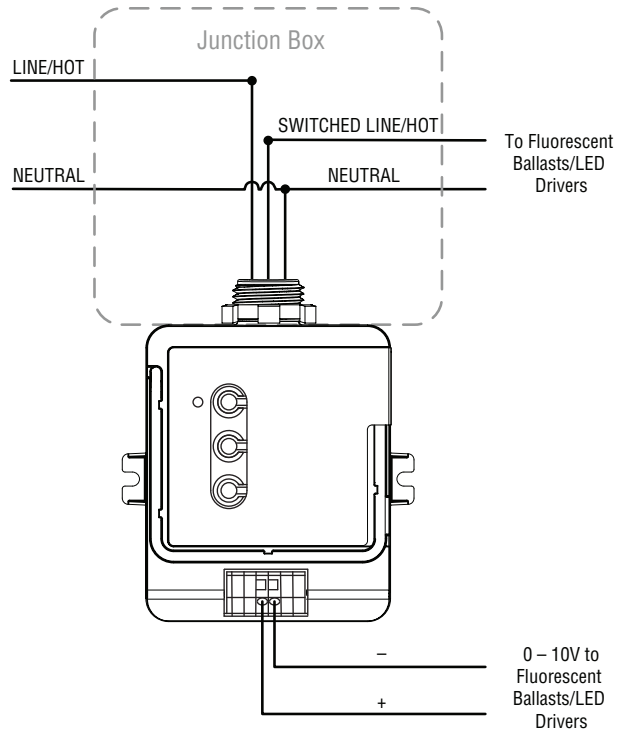



Advanced Configurations

Wireless Switches

- Up to 10 switches can be connected, each with set favorite levels

Ceiling-mounted Wireless Daylight Sensor

- Ceiling-mounted wireless daylight sensor will affect the connected ballasts and LED drivers equally
- For multiple rows of daylighting, a separate dimming module must be used for each daylighting row

Minimum Light Level Setting (optional)

- Certain applications such as hallways, may require that the lights never turn off. For these areas, select the minimum light level option and the load will lower to programmed low-end level. Default operation lowers to OFF

High- and Low-End Trim

- High-end and low-end trim affect all connected fixtures equally, and can be configured from the dimming module or from any associated wireless switch when unit is not in programming lock-out mode
- Adjustable low-end trim (0-45%). Trimmable low-end can ensure a stable light level. Some fixtures will flicker or drop out if trimmed too low

- The maximum light output of connected fixtures can be decreased down to 55% for energy savings in over-lit spaces. The perceived light output of low-end trim may vary between fixture manufacturers and model numbers. For best results do not mix different ballasts or drivers on the same 0-10V circuit

Ceiling-mounted Wireless Occupancy Sensors

- Ceiling-mounted wireless occupancy and vacancy sensors control all connected ballasts or drivers
- Wireless switches can be used to adjust the Occupied levels of fixtures that they control from 1% to 100% (of output signal) or can make them unaffected by Occupancy events
- Vacancy events (area becomes unoccupied) turn all ballasts and driver models OFF or to minimum lighting level

Programming Lockout

- Once enabled, all wireless switches can no longer perform programming or set favorite levels
- To change settings, programming lockout must be unlocked by a button combination directly on the dimming module

System Diagram

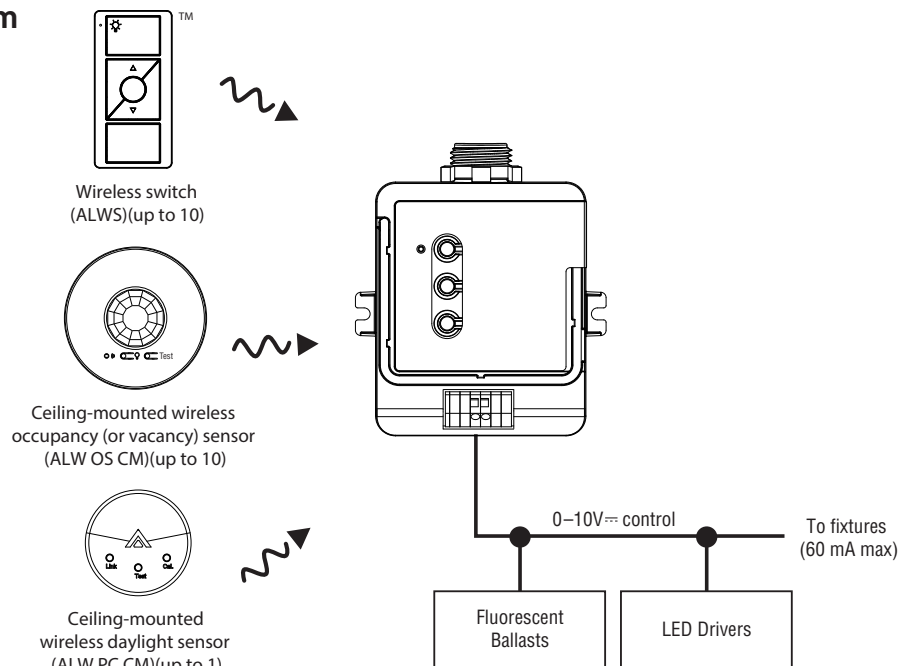



AirLink™
enabled by Lutron®

8AMP Power Pack with 0-10V Dimming

The AirLink System

Wireless controls & sensors



Wireless remotes & switches



Occupancy/Vacancy & Daylight sensors



AirLink-integrated Fixtures



AirLink-compatible Fixtures



Plug load controllers

Centralized control & integration

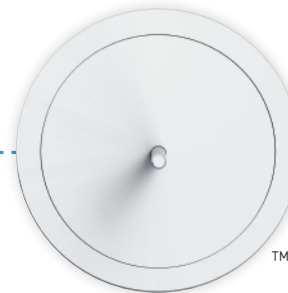

Wireless hub

Wired / Ethernet



Demand Response



BACnet integration

Simple-to-use software

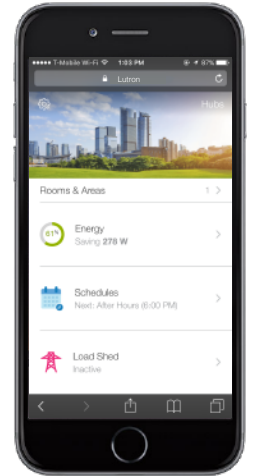

Lighting control web app

Contact LSI Controls



Sales
controls.sales@lsi-industries.com



Support
controls.support@lsi-industries.com
1 (800) 436-7800 (support, option 8)



More information
For more information on AirLink, visit our website at www.lsi-airlink.com/airlink