



DECO® LIGHTING

DSW-LED

Surface Wraparound



Job Information

Type:	
Catalog #:	
Project:	
Comments:	
Prepared by:	

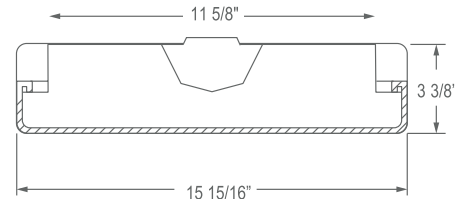
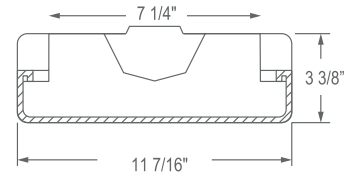
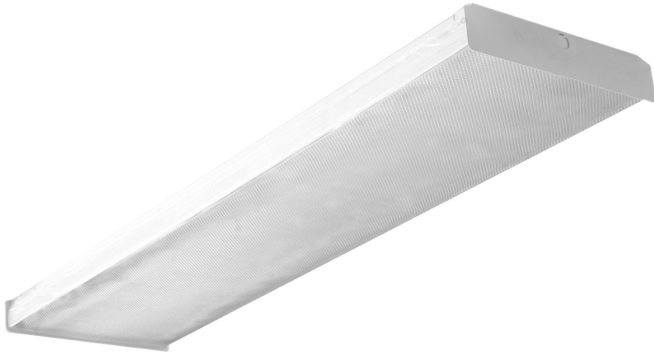

Description

The DSW series wraparound features economy and energy efficient performance. The luminaire's characteristic, clean, low-profile design is both appealing and practically functional. This unit utilizes a clear, low brightness, extruded acrylic refractor and a heavy gauge steel end plate with embossed light seal for dependable performance and good looks. The DSW wraparound is perfect for commercial spaces, school dormitories, offices and retail areas.

Ordering Information

Example: (DSW-LED-4-N-35-40-UNV-EM)

DSW-LED											
Series	Length	Body Type	Wattage/Lumen	Color Temp.	Voltage	Option					
Surface Wraparound	2 2'	N Narrow	22 22W/2890 ^{1,2,3}	30 3000K	UNV 120-277V	DM Dimming (0-10V)					
	4 4'	W Wide ⁴	35 35W/3780 ^{2,3}	35 3500K	120 120V	CSC Control Scope Connected					
			45 45W/5058 ^{2,3}	40 4000K	277 277V	EM Emergency					
			60 60W/6744 ²	50 5000K							

¹2' available in 22W only

²Delivered Lumens (5000K) - See lumen chart on Page 2

³DLC-Listed Wattage, View DLC matrix on Page 2 for breakdown of models that are currently listed.

⁴Wide body not available for 2-foot model.

Deco Lighting practices a program of continuous product development, and as a result product specifications change frequently. We reserve the right to change product specifications without notice. Contact Deco for the latest product information.

©2016 Deco Lighting, www.getdeco.com T: (800) 613-DECO F: (310) 366-6855
Rev Date: 2/14/17 #3



Digitize your light.®

Features

- Die formed heavy gauge steel with side flanges for extra uniformity and rigidity.
- Ballast cover snaps into housing to cover ballast and wires.
- Socket plates slide on for easy wiring.
- Fixture ends are die-formed for rigidity.
- Post painted powder coated white finish.
- Diffuser is designed for one-piece .125" thick prismatic lenses.
- Snap on diffusers for easy servicing and hinge from either side.
- May be surface or stem mounted, individually or in continuous rows.
- UL listed for damp locations.
- DLC Listed for utility rebates (Please see matrix below).

DLC Listing

	Narrow			Wide	
	2'-22W	4'-35W	4'-45W	2'-22W	4'-45W
3000K					
3500K	X	X	X	X	X
4000K	X	X	X	X	X
5000K	X	X	X	X	X

Lumen Output

Lumen Chart					
Body Type	Wattage	5000K	4000K	3500K	3000K
Narrow	22	2890	2791	2735	2598
	35	3780	3402	3232	3070
	45	5058	4894	4809	4569
	60	6744	6070	5766	5478
Wide	22	2668	2584	2539	2412
	35	3640	3276	3112	2957
	45	4640	4494	4416	4195
	60	6187	5568	5290	5025

*Lumen outputs are based on 5000K performance data and then scaled down to the other temperatures.