

DLED-CFK6

6" NON-IC Frame-in LED Kit

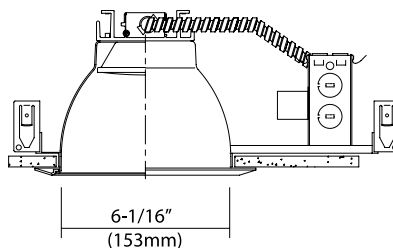

5-5/8"
(143.2mm)



6-1/16"
(153mm)

7-5/8"
(194mm)

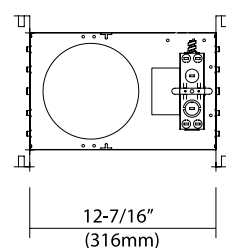

12-7/16"
(316mm)

Ceiling Cut-out : 6"-1/2"

Optional: Easy-quick connector case
(patent pending)



Description

6" flat frame-in kits combined with LED module and integral reflector. This is designed for use in non-insulated ceiling. Insulation material must be kept a minimum of 3" from fixture. Provided in high efficacy LED with dimmable driver and the special optical diffusion allows high lumen transmission and light uniformity.

Ordering Information

Example: (DLED-CFK6-14A-50-DLEDT-R622-UNV-DM)

DLED-CFK6

Series	Wattage/Lumens	Color Temp.	Trim	Voltage	Options
6" NON-IC Frame-in LED Kit	14A 14W/950 23 23W/1790 30 30W/2235	30 3000K 35 3500K 40 4000K	See page 3	UNV 120-277V ¹	DM Dimmable ² ECQ Easy-Quick Connector case EM Emergency

¹Triac 120V low voltage electronic dimmer switches
²0-10V dimmer switches

Job Information

Type:	
Catalog #:	
Project:	
Comments:	
Prepared by:	

Features

- Mounting Frame**
 20-gauge CRS mounting ring, black-painted. 1-5/8" deep collar may use for various thickness of ceiling materials.
- LED module & Trim**
 Aluminum extruded Heat sink designed to facilitate heat dissipation to reduce LED junction temperature for maintaining constant light output, color and life of solid state components.
 Module construction includes LED, heat sink and lens.
 Heavy gauge aluminum reflector anodized in clear, haze, gold, champagne and pewter color finish.
 Reflectors may provide with black and white milled groove baffle collar.
- Junction Box**
 Listed for through branch circuit wiring. (Max. 8 No 12 AWG 90°C branch circuit conductors. (4 in, 4 out) (5) 1/2" knockouts with true pry-out slots and (4) knockouts with Romex cable clamp.
 Ground wire provided on J-box.
- Mounting Channel Bracket**
 Commercial mounting kit provided up to 5" vertical adjustment, which accommodates 1/2" EMT conduit, optional HB-24 or HBC-24 bar hanger or lathing channels for T-bar grid or concealed spline ceiling.
- Electrical**
 120~277V input high efficacy drivers with the capability to dim by 1a Triac 120V low voltage electronic dimmer switches, or 2b 0-10V dimmer switches.
 Driver feature power factor >.90, THD <20% and has integral thermal protection to sense over temperature or internal failure.
 Driver mounts externally to the module, allowing future replacement, if needed.
 Consult with factory for optional 0-10V analog dimmable driver.
- Options**
 Emergency battery back-up: Available in mounted to fixture or remote adjacent to luminaire (consult with factory for exact application).
- Warranty**
 50,000hrs of lamp life.
- Listing**
 ETL Listed. CA Title 24.

Photometry

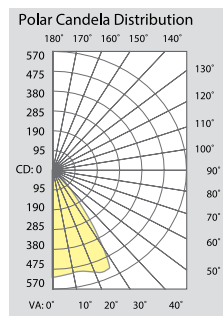

Illuminance at a Distance

	Center Beam FC	Beam Width
2.0ft	138.2 fc	3.0ft
4.0ft	34.6 fc	6.0ft
6.0ft	15.4 fc	9.0ft
8.0ft	8.6 fc	12.0ft
10.0ft	5.5 fc	15.0ft
12.0ft	3.8 fc	18.0ft

Beam Spread: 75°

14W

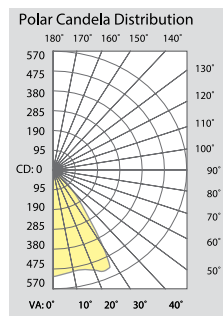

Illuminance at a Distance

	Center Beam FC	Beam Width
2.0ft	316.1 fc	2.4ft
4.0ft	79.0 fc	4.9ft
6.0ft	35.1 fc	7.3ft
8.0ft	19.8 fc	9.8ft
10.0ft	12.6 fc	12.2ft
12.0ft	8.8 fc	14.7ft

Beam Spread: 75°

30W

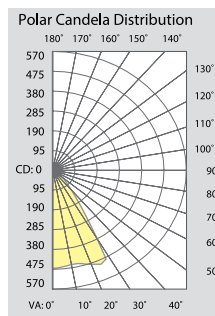

Illuminance at a Distance

	Center Beam FC	Beam Width
2.0ft	244.2 fc	3.0ft
4.0ft	61.0 fc	6.1ft
6.0ft	27.1 fc	9.1ft
8.0ft	15.3 fc	12.2ft
10.0ft	9.8 fc	15.2ft
12.0ft	6.8 fc	18.2ft

Beam Spread: 75°

23W

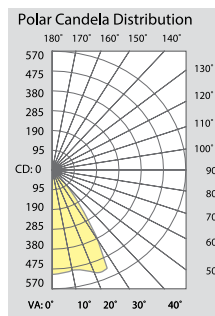

Illuminance at a Distance

	Center Beam FC	Beam Width
2.0ft	369.4 fc	2.9ft
4.0ft	92.4 fc	5.8ft
6.0ft	41.1 fc	8.7ft
8.0ft	23.1 fc	11.6ft
10.0ft	14.8 fc	14.5ft
12.0ft	10.3 fc	17.3ft

Beam Spread: 75°

45W

Trims

DLEDT-R64 Specular Open Reflector	DLEDT-R614 Baffle w/ Reflector	DLEDT-R641 Baffle w/ Regressed Lens
		
		
DLEDT-R622 Reflector w/ Regressed Lens	DLEDT-R636 Wall Wash w/ Kick-Off Plate	DLEDT-R640 Reflector w/ Frosted Floating Lens

All trims are rated for damp location and regressed lens trims are wet location listed.