



DECO | LIGHTING

D811-LED

Decorative Outdoor Luminaire



Job Information

Type:	
Catalog #:	
Project:	
Comments:	
Prepared by:	

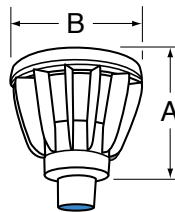

	Size = 10	Size = 20
A	13"	18"
B	13"	21"

Description

The D811-LED Vandalproof Outdoor Luminaire sets the standard in flexibility for area lighting in high-vandalism areas. Rugged, heavy-gauge, spun aluminium housing, and fully gasketed for weathertight integrity. Standard finish is dark bronze, but other architectural colors are available. The Vandalproof Outdoor luminaire offers unparalleled variety in one family of fixtures. Ideal for streets, parking lots, and surrounding areas. U.L. listed and CSA certified for wet locations.

Ordering Information

Example: (D811-LED-10-60-30-UNV-T5-2L-DB-WDF)



Series	Size	Wattage/Lumen		Color Temp.		Voltage		Optics		Mounting		Finish		Option		
Decorative Outdoor Luminaire	10	13" Dia.	60	60W/6552 ^{3,6}	30	3000K	UNV	120-277V	3	Type 3	PT3	Post Top 3" Tenon ¹	DB	Dark Bronze ¹	SM	Smart Dim
	20	21" Dia.	80	80W/8736 ^{3,6}	35	3500K	347	347V	T5	Type 5 ¹	OT	Other Tenon MT ⁸	BK	Black	PC	Photocell ⁵
			100	100W/10920 ^{3,6,7}	40	4000K	480	480V					GR	Green	WSF	Wired Single Fuse ⁵
			120	120W/13104 ^{3,6,7}	50	5000K ⁴	(Step-Down Transformer used for 480V Divider)						SL	Silver	WDF	Wired Double Fuse ⁵
						BU	Blue	CSF					Custom Slip Fitter			
												VP	Verde Patina			*Requires additional control device, see Page 3 for more info
												CC	Custom ²			

¹ Standard for fixture
² Contact factory for custom finish
³ Delivered Lumens (5000K)
⁴ Standard Color Temp.
⁵ Specify Voltage (eg. 120V)
⁶ 60W & 80W (13" Dia.); 100W & 120 (21" Dia.)
⁷ Smart Dim Available
⁸ Refer to pg 3. Please note that this is a separate order.

Deco Lighting practices a program of continuous product development, and as a result product specifications change frequently. We reserve the right to change product specifications without notice. Contact Deco for the latest product information.

©2016 Deco Lighting, www.getdeco.com T: (800) 613-DECO F: (310) 366-6855
 Rev Date: 7/27/16 #1

Features

- Housing is heavy duty spun and cast aluminum.
- Standard external slipfitter is cast aluminum and is designed to fit a 3" OD pole or tenon.
- Large housing has 18 fins, small housing has 12 fins, both @ 20" apart;
- The fins protect the luminaire from vandalism and thrown objects.
- Standard color is bronze; also available in black and white. Contact factory for custom finishes.

Photometric Data

D811-LED 120W Type II

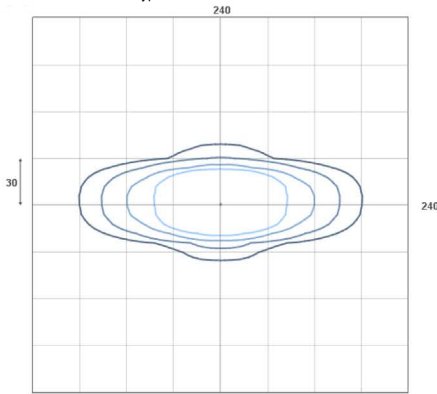

Calculation Area:	240'x240'
Point Spacing:	24'x24'
Max Luminance:	5.2 fc
Area > 0.5fc:	4536 ft²

D811-LED 120W Type III/ Type IV

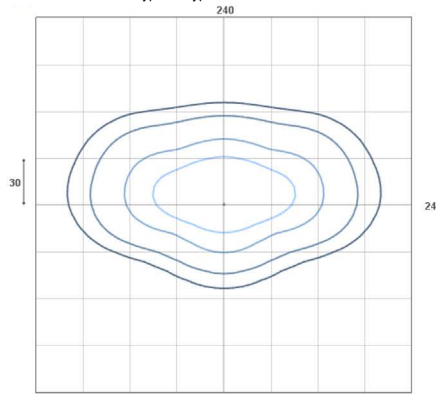

Calculation Area:	240'x240'
Point Spacing:	24'x24'
Max Luminance:	2.9 fc
Area > 0.5fc:	6732 ft²

D811-LED 120W Type V

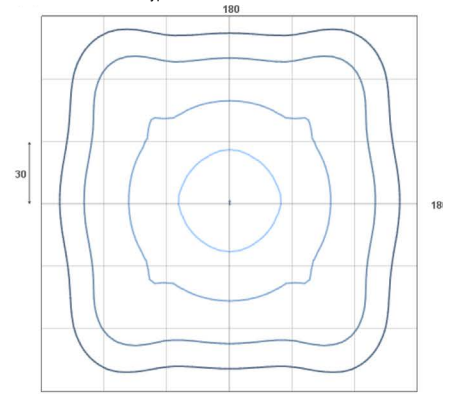

Calculation Area:	180'x180'
Point Spacing:	18'x18'
Max Luminance:	1.9 fc
Area > 0.5fc:	7533 ft²

Performance Data

CRI:	80+			
CCT:	3000K, 3500K, 4000K, 5000K			
Warranty:	10 yr. Limited Warranty			
Dimming:	Available with 0-10V inputs dimming down to 10%			
Operating Temperature:	0°-60°C Max Ambient			
L70 Rating:	100,000+ Hours			
EPA:	1.2 / 2.1			
IP Rating:	IP65			
Driver Current:	700mA			
Sound Rating:	Class A (inaudible in a 24dB ambient environment)			
BUG Rating:	Type 2	B3	U2	G2
	Type 3	B3	U2	G3
	Type 5	B4	U1	G2

Delivered Light Output & Equivalency Chart

HID to LED Replacement		
DELIVERED LUMENS	HID	LED Replacement
1300lm	50W	10W
2600lm	70W	20W
3900lm	100W	30W
5200lm	150W	40W
7800lm	175W	60W
11700lm	250W	80W
15600lm	400W	120W
26000lm	750W	200W
31200lm	1000W	240W

Interested in upgrading from HID to LED lighting? Use the conversion table above to get a general idea of what wattage LED fixture will replace your current lighting system. Lumen output and overall performance will vary by fixture, so please contact our factory or your nearest sales rep regarding specific questions on what wattage will best suit your desired space and application.

Smart Dim Options

Please Note: The Smart Dim option requires a control device, such as a photocell or other centralized system, in order for the unit to function properly.

Maximize energy-savings with the Dynadimmer 0-10V luminaire-based control for outdoor applications

Dynadimmer 0-10V is a lamp control device that enables high energy savings with low installation efforts. The small, stand-alone, luminaire-based device can drive a 1-10V electronic ballast to facilitate on-demand light levels and does not require an additional switching wire. The Dynadimmer 0-10V dimming schedule is flexible with up to five dimming levels and five time periods. Easy-to-operate software and programming equipment enable end users to re-program dim times and levels when and as they wish. Offering energy-efficiency and flexibility, the Dynadimmer 0-10V control is ideal for residential, roadway, parking, and industrial applications.

VIEW FULL SENSOR SPEC SHEET BELOW:

http://www.getdeco.com/wp-content/themes/deco-digital/pdf/PA-7320-B-Dynadimmer_v2_web.pdf



The Dynadimmer 0-10V solution offers:

- Reduced energy usage through dimming
- Reduced light nuisance
- Very small size; fits inside almost any luminaire
- Easy-to-use software provides a forecast of energy savings

Other Tennon

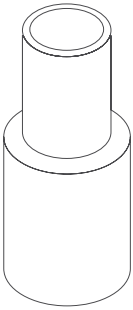

DRETA-3.5-TN3 (PT3.5)	Round External Tennon Adapter to Slip Over 3.5" Diameter Round Pole to 3" Post Top
DRETA-4-TN3 (PT4)	Round External Tennon Adapter to Slip Over 4" Diameter Round Pole to 3" Post Top
DRETA-5-TN3 (PT5)	Round External Tennon Adapter to Slip Over 4" Diameter Round Pole to 3" Post Top
DRETA-6-TN3 (PT6)	Round External Tennon Adapter to Slip Over 4" Diameter Round Pole to 3" Post Top

Please note that this is ordered separately